



Flight Light Inc.
 2708 47th Ave.
 Sacramento, California, U.S.A.
 95822-3806

atg airports (formerly ALSTOM)
Vehicle Undercarriage
Security Inspection Light

PH (916) 394-2800 **FX (916) 394-2809**
TF (800) 806-3548 **EM info@flightlight.com**

General Description

The ZA292 fixture is designed to aid security and safety inspectors by providing high-intensity illumination of vehicle undercarriages. Features include outstanding durability, superior visibility, and low maintenance.

Security applications for the ZA292 include: military bases, airports, maritime ports, border crossings, correctional facilities, courthouses and other government buildings. Safety applications for the ZA292 include: weigh stations, manufacturing plants and vehicle maintenance facilities.

Why Our ZA292 is Better

Outstanding Durability

- Corrosion resistant anodized aluminum body provides resistance to weathering.
- High static load rating (44,000 lb.) reduces likelihood of damage from heavy vehicles.

Superior Visibility

- Light source exceeds 600,000 candela/meter, providing high-intensity illumination for improved visibility.

Low Maintenance

- Self-cleaning lens design reduces build-up of dirt and need for frequent cleaning.
- Pre-focused optics eliminates the requirement of field adjustments.
- Pressurized light cavity keeps moisture out and reduces the frequency of replacement.
- Long life lamps (Avg. Rated Life of 2,000 hours) reduces frequency of replacement.
- Adhesive/sealant free prism design reduces time and effort during maintenance.

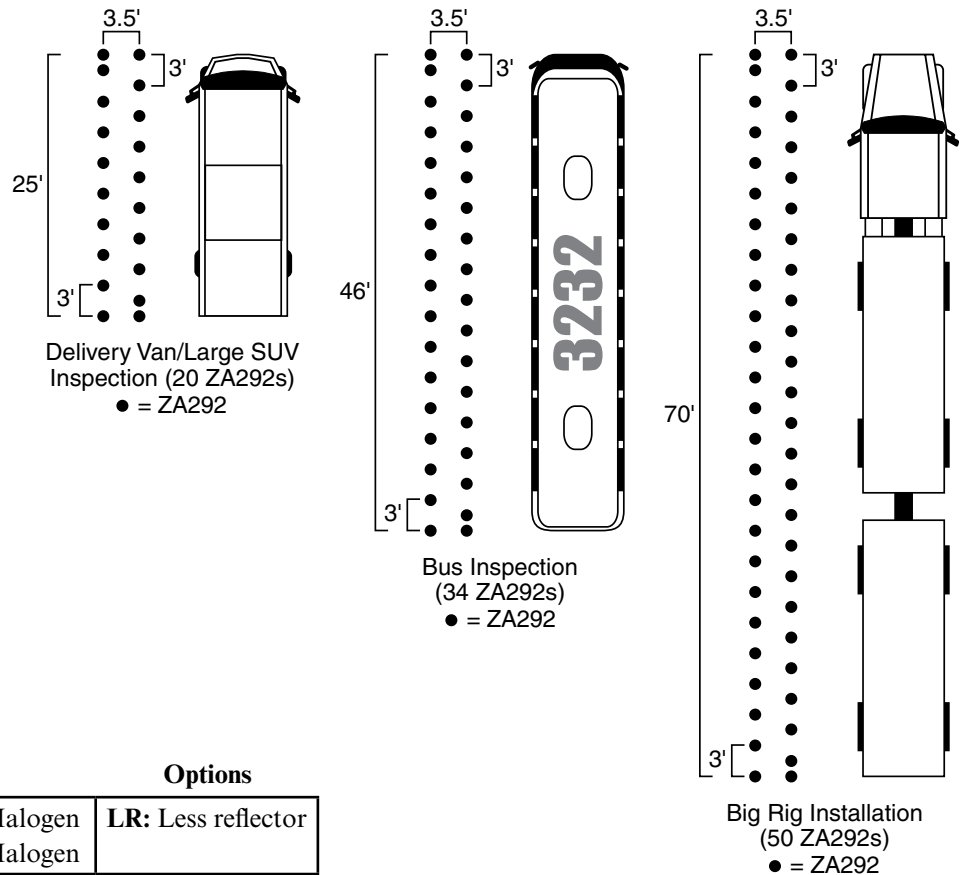

Ordering Codes

Fixture	Color	Lamps	Options
80-ZA292A	C: Clear	50: 50W, 120V Halogen 52: 50W, 220V Halogen	LR: Less reflector

Visit our web site: www.flightlight.com



Flight Light Inc.
 2708 47th Ave.
 Sacramento, California, U.S.A.
 95822-3806

PH (916) 394-2800 **FX (916) 394-2809**
TF (800) 806-3548 **EM info@flightlight.com**

atg airports (formerly ALSTOM)
Vehicle Undercarriage
Security Inspection Light

Common Replacement Parts

1	Body Casting (Std) – Golden Yellow	ALT	Green Prism Dome	80-019183	
2	Bottom Cover Casting	80-040101	ALT	Yellow Prism Dome	80-019181
3	Elkay Gland Set	80-021114/5/6	ALT	Red Prism Dome	80-019182
4	Bottom Cover Gasket	80-033080	20	50W 110/120V Reflector Lamp	LA-008084
6	Prism Clamp	80-021307	22	Lamp Gasket	80-033077
8	Bottom Cover Spinning Clamp	80-021311	23	Lamp Retaining Spring	80-032039
14	Body/Base Gasket	80-033093	24	'B' Type Male Lead	CO-10518-114-D02
15	Prism Clamp Gasket	80-021309	25	Pressure Test Plug	80-021256
16	Prism Gasket	80-033090	ALT	Schraeder Tank Valve	80-021327
18	Blue Prism Dome	80-019180	31	120V/240V lamp holder	80-015057
ALT	Clear Prism Dome	80-016077			

How to Specify the ZA292 High-Intensity, Self-Cleaning, Omni-Directional Fixture

The fixture shall be model 80-ZA292AC50 as marketed by Flight Light Inc. or approved equal. In order to be considered equal, the alternate fixture shall satisfy the following requirements.

Construction - The fixture shall be omni-directional and of modular clam shell design comprised of two high strength aluminum castings with the main glass prism being fastened to the upper casting without the use of sealants. The finish of the upper casting shall be natural anodized and be grey in color. The bottom casting shall be painted black. The top and bottom castings shall be sealed by means of a flat gasket and shall have indexing pins to insure proper seating. The fixture shall project no more than 0.39" above the roadway when installed in the factory supplied mounting base. The diameter of the fixture shall not be more than 8" and all mounting hardware shall be stainless steel. The fixture shall operate on 120 VAC and shall be furnished with a waterproof 90P plug.

Durability - Fixture shall withstand a static load of 44,000 lb. without sustaining permanent deformation or cracking of materials. Leads, gaskets, etc. shall be rated to withstand 300 degrees F.

Lamp/Light Cavity - The lens shall be molded of high performance optical grade glass and formed to provide a sealed fit within the fixture and shall be gasketed by high density silicone rubber. The lamp shall be an off-the-shelf 50-watt MR16 120V halogen lamp with an average rated life of 2,000 hours when operated at design voltage. The lamp mounting arrangement shall result in the lamp being prefocused for ease in maintenance. To prevent moisture intrusion, each fixture shall be installed with a Schraeder valve to facilitate verification that the entire assembly is sealed at the time of installation and to allow for re-testing after maintenance.

Photometric Performance - The light output from the prefocused optics shall exceed 600,000 candela per meter squared.

Mounting Base - Fixture shall be installed in mounting base (P/N 35-868AA.5-5) of high strength steel, hot dip galvanized after fabrication per ASTM-153 specifications, with a 7.25" diameter bolt circle, a 0.75" mud ring, and standard base depth of 10". The base shall be supplied with a plywood cover to protect the mounting flange during installation.

Warranty - Fixture shall be warranted by the manufacturer against defects in materials and workmanship for one year from the date of shipment in non-snowplow applications. The lamps are not warranted.

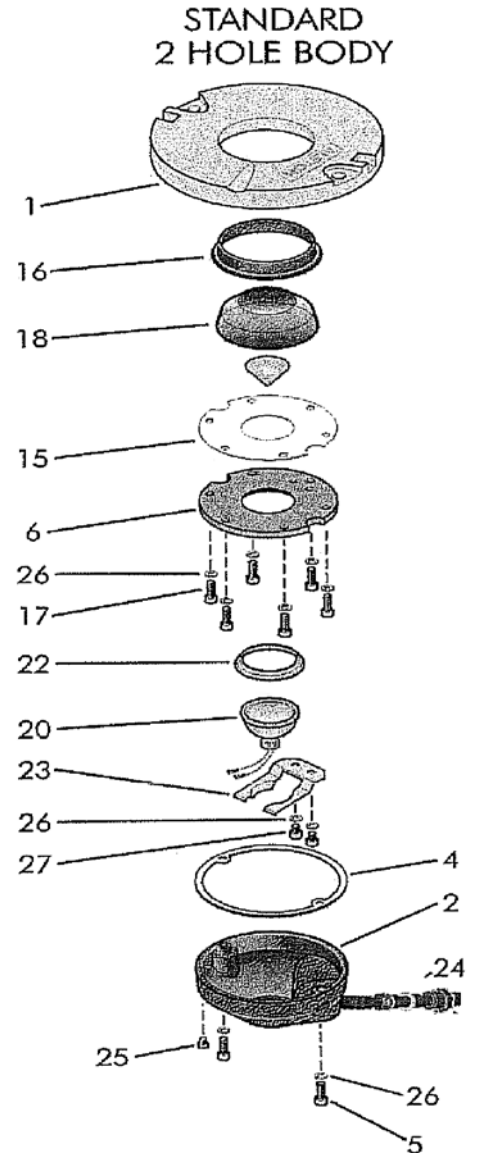

Visit our web site: www.flightlight.com